

This is not a certified copy

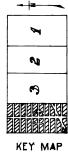

PALM BEACH PARK

BEING A SUBDIVISION OF THE N 1/4 OF SEC 26 T43 S R37 E
PALM BEACH COUNTY, FLA.

BRIDGEMAN AND ALLEN, INC.
ENGINEERS
307 GARDENIA ST.
WEST PALM BEACH, FLA.

MARCH 1926

2640

SCALE: 1" = 100 FT.

Plat No. 30 and Report of April 26, 1926

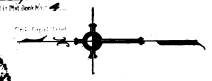

81

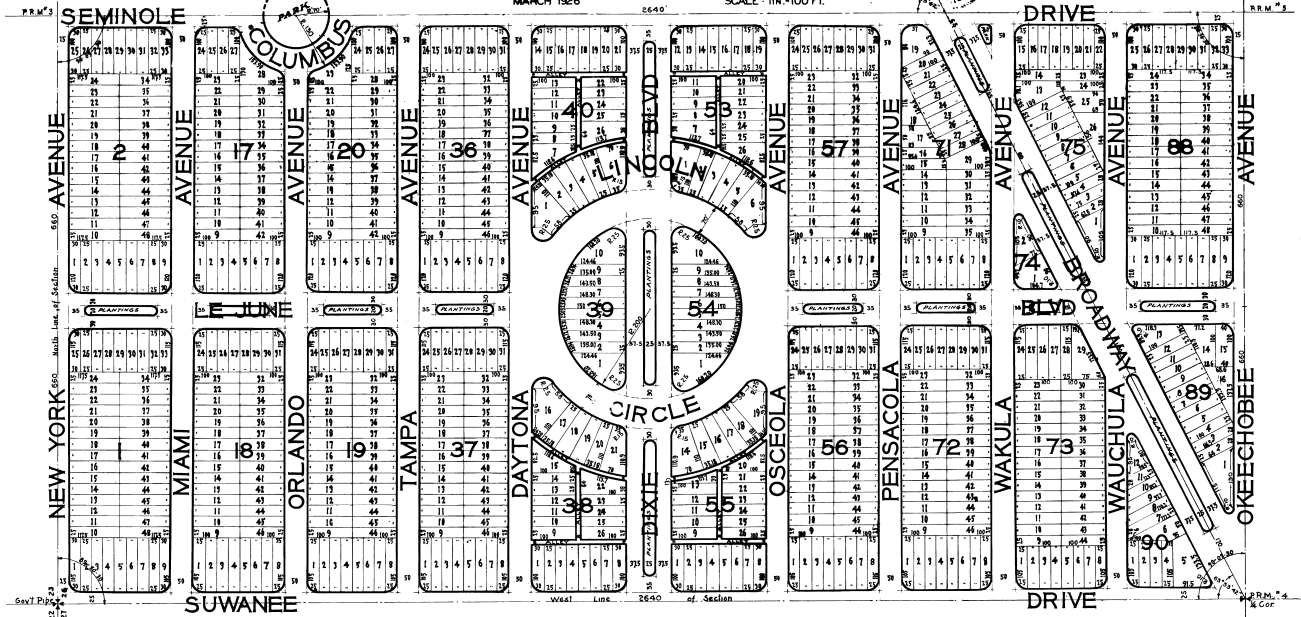

Note: Diagrams on copper file are in strict accordance of street lines extended except where otherwise shown as shown on plan. All radii are 25 feet unless otherwise shown.

Approved by Board of County Commissioners
CC. C. ...
County Engineer